

Base Front view
Scale: 1:2

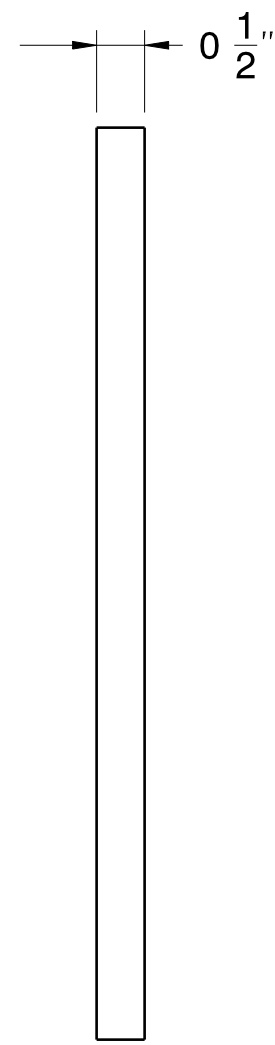

Base Right view
Scale: 1:2

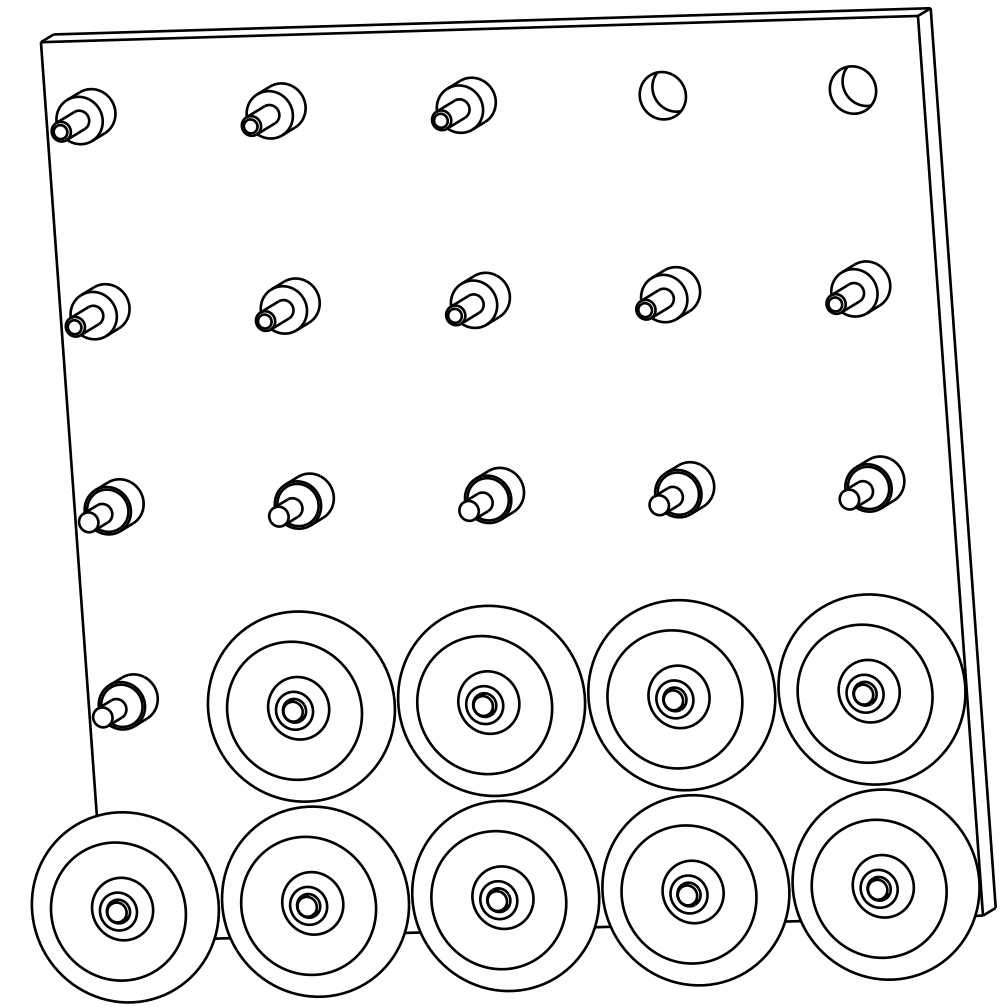

Assembly Isometric view
Scale: 1:2

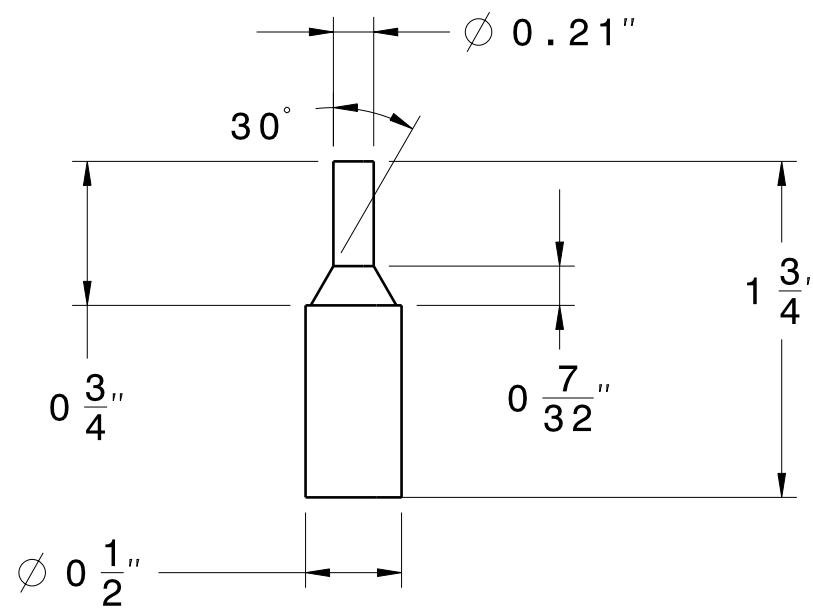

Standoff Front view
Scale: 1:1

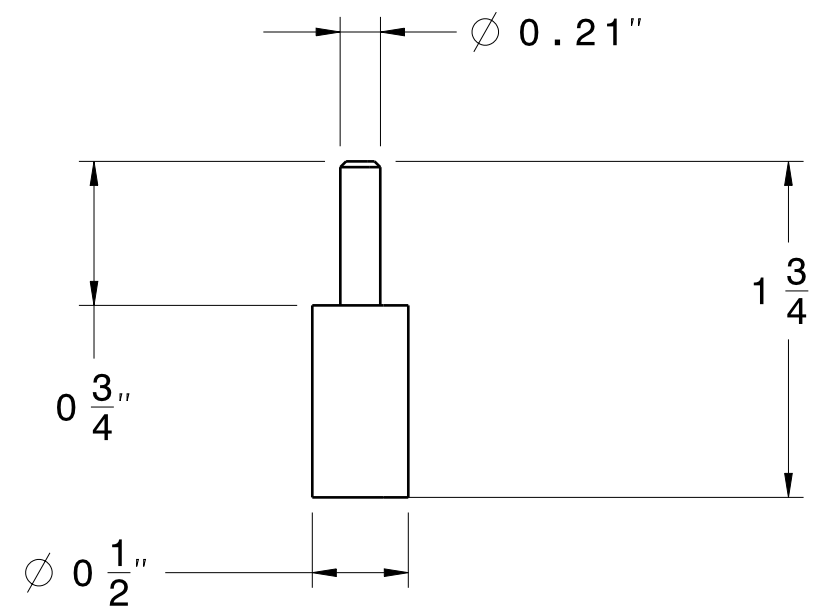

Optional Standoff Front view
Scale: 1:1

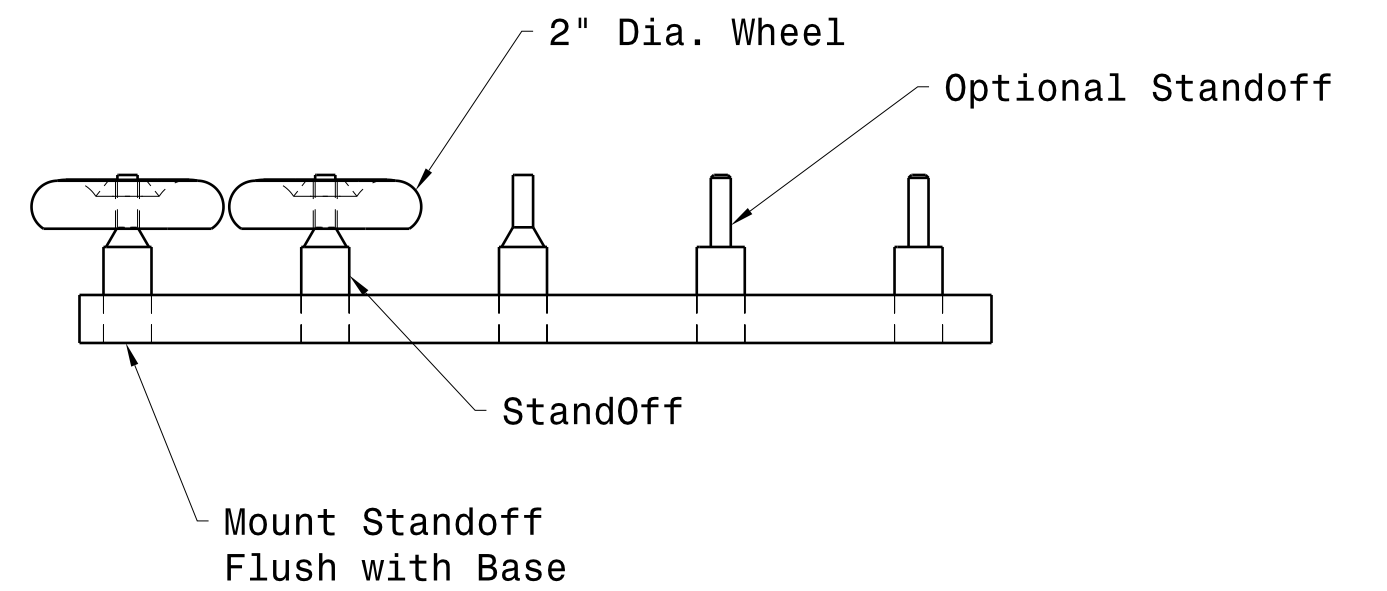

Assembly Front view
Scale: 1:2

Standoff Hole Spacing		
Wheel Dia	Vertical Spacing	Horizontal Spacing
2"	2-1/16"	2-1/16"
1-1/2"	1-17/32"	1-17/32"
1-1/4"	1-9/32"	1-9/32"
1"	1-1/32"	1-1/32"

MATERIAL LIST			
Component Description	Number Req'd	Size	Material
Base	1	9-1/2" x 9-1/2" x 1/2"	Birch Ply
StandOff	25	1/2" Dia. x 1-1/2" Long	Plastic Dowel
Optional Standoff	25	1/2" Dia. x 1-1/2" Long	Plastic Dowel

This drawing is our property. It can't be reproduced or communicated without our written agreement.

DRAWN BY D R McCagg	DATE 12FEB2021
CHECKED BY XXX	DATE XXX
DESIGNED BY D R McCagg	DATE 12FEB2021

Ken Wolf Design			
DRAWING TITLE Toy Wheel Coating Jig			
SIZE C	DRAWING NUMBER Wheel Paint Fixture 2-12-21 A	REV A	
SCALE As Shown	WEIGHT(kg) 2.50	SHEET 1/1	

